

PORTABLE Steamer

Instruction Manual



Item No. 41970

IMPORTANT! SAFETY INSTRUCTIONS:



READ THIS MANUAL BEFORE USING THIS APPLIANCE.



**WARNING! READ ALL SAFETY WARNINGS AND INSTRUCTIONS
FAILURE TO FOLLOW THE WARNINGS AND INSTRUCTIONS
LISTED BELOW MAY RESULT IN ELECTRIC SHOCK, FIRE AND/OR
INJURY**

- **The intended use of this appliance is explained in this manual. The use of accessories other than those recommended in this manual may present a risk of personal injury.**
- **Always check the mains voltage corresponds to the voltage on the rating plate.**
- Do not place the product too close to any heat emitting appliances or in direct sunlight.
- Check that the voltage indicated on the data plate corresponds with that of the local network before connecting the appliance to the mains power supply.
- Do not leave the appliance unattended whilst connected to the mains power supply.
- Do not immerse the appliance in water or any other liquids.
- It is imperative to unplug the appliance from the mains power supply after it has been used, before it is cleaned and whilst being repaired.
- Close supervision is required when using this product near children.
- Never leave the appliance within reach of children.
- Repairs to electrical appliances should only be performed by a qualified electrician. Improper repairs may place the user at serious risk.
- This appliance is intended for household use only and should not be used for industrial purposes.
- Do not operate this appliance with a damaged plug or cord, after a malfunction, or after being dropped or damaged in any way.
- Do not use this appliance for anything other than is intended use.
- Steam produced by this unit is hot and pressurised. Care must be taken to avoid burns or other injuries.
- Do not shake the appliance whilst in use to avoid hot water splashing out.

- Always ensure the unit has cooled thoroughly before re-filling with water, cleaning or storing.
- Always disconnect the appliance from the mains power supply when filling or emptying water. Ensure the water tank is emptied after each use before storing.
- Do not add chemicals or detergents to the water tank as they will damage the unit.
- The nozzle and accessories become hot during use. Do not touch the nozzle or attempt to change the accessories whilst the appliance is in use.
- Always hold the unit upright and do not fill past the Max mark to avoid burns from splashing water.
- Use the unit with extreme caution with a tilted angle not more than 35° in any direction to avoid excess water spilling from the steam head.
- Always hold the unit away from the body and do not aim at people or animals.
- Do not operate the appliance if the steam opening is blocked.
- Always drain the remaining water from the appliance after each use to avoid the mineral build-up in the heating plate.
- This appliance can be used by children aged from 8 years and above and persons with reduced physical, sensory or mental capabilities or lack of experience and knowledge if they have been given supervision or instruction concerning use of the appliance in a safe way and understand the hazards involved. Children shall not play with the appliance. Cleaning and user maintenance shall not be made by children.

DESCRIPTION OF PARTS

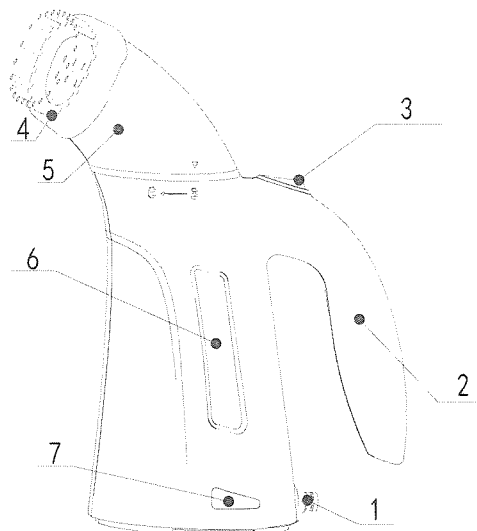

1. Power Cord
2. Handle
3. On/Off Switch
4. Steam Brush
5. Water Tank Cap
6. Water Tank
7. Light

ACCESSORY ASSEMBLY

- This appliance is supplied with one accessory:
Fabric Brush - Smoothes wrinkles and creases from fabrics
Follow the steps below to attach the accessory to the steam nozzle:
 - Ensure the unit is turned Off and no steam emits from the nozzle.
 - Choose the required attachment and slide onto the steam nozzle.
 - Ensure the holes on the steam nozzle are aligned with the open slots on the accessories so that steam does not get blocked.
 - CAUTION: To avoid burns do not attach accessories to the nozzle whilst steam is emitting.

INSTRUCTIONS FOR USE

FILLING THE WATER TANK

WARNING! ENSURE THE GARMENT STEAMER IS UNPLUGGED AND COOLED BEFORE RE-FILLING THE TANK.

- Ensure you place the Garment Steamer on a flat stable surface, holding the handle, twist the nozzle section of the Steamer clockwise to release.
- Fill the Garment Steamer using plain water, distilled or de-mineralised water.
- Fill the Water Tank up to the MAX mark, do not over fill the tank.
- Replace the Nozzle and twist to secure into place.

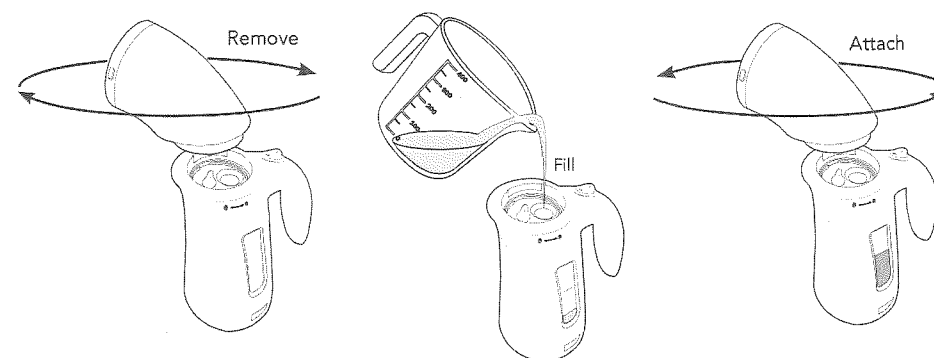

CAUTION:

- After each use, always allow the unit to cool for approx. 8 minutes before adding cold water; cold water added to a hot boiler may cause hot water and steam to shoot from the fill hole.
- Extreme caution is required when pouring water into the water tank.
- Never fill water past the Max fill line.

NOTE:

- Use of distilled or de-mineralised water is recommended to prolong the life of the steamer.
- Use water only; do not use detergents or other chemical substances.
- Misuse will lead to an invalid guarantee.

STEAMING LINENS AND FABRICS

- Ensure the water tank has been filled and that the desired accessory is connected and then follow the steps below:
 - Plug the unit into the mains power supply and switch On if switchable.
 - Switch the unit On and the button will illuminate to indicate the appliance is on.
 - Steam will emit from the nozzle after approximately 2 minutes.

- Direct the steam nozzle with either one of the accessories towards the material you wish to steam.
- Keep the flow of steam focused on the material being steamed.
- Using a slight back and forth motion over the area you are steaming will further enhance the process.
- **CAUTION: Always be sure that the Steam Nozzle and any other attachments are pointed in a safe direction away from the user, other people and animals when steam is being emitted.**

STEAMING GARMENTS

- Place the garment on a clean rust-free hanger.
- Direct the steam nozzle towards the bottom of the garment.
- Steam will rise on both the inside and outside of the fabric removing the wrinkles and creases. Slowly slide the steam nozzle upwards from the bottom to the top of the garment.
- Direct the steam nozzle away from the garment and smooth the fabric with your free hand.
- Repeat as necessary until the garment is crease-free.

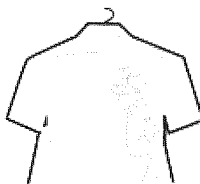

STORAGE

- Unplug the power cord from the mains power supply.
- Allow the unit to cool thoroughly (at least 60 minutes).
- Remove all attachments from the unit.
- Drain the remaining water from the water tank to minimise potential mineral build-up. Loosely replace the water tank cap but do not tighten as it may be difficult to unscrew for future use.
- Store all accessories with the unit in a dry, cool location.

REMOVING MINERAL BUILD-UP

- Different water sources contain minerals and the sediment may cause mineral build-up in the steamer and affect the free flow of steam.
- **NOTE: The best way to avoid mineral build-up is to use distilled or de-mineralised water. If you are unable to do this it is recommended to use the mineral build-up removal procedure.**
- Unplug the unit and allow to cool completely (at least 60 minutes).
- Remove all accessories from the unit.
- Remove the water tank cap and drain any remaining water from the water tank.
- Slowly pour the mixture into the water tank.
- Allow the unit to stand for 1-2 hours.
- Drain the solution from the water tank.
- If the mineral build-up still remains in the unit, repeat the above steps until all build-up is removed.
- Rinse the water tank with fresh water, drain and repeat until the vinegar odour is eradicated.
- Replace the water tank cap.

TROUBLESHOOTING

PROBLEM	POSSIBLE REASONS	SOLUTION
Unit fails to heat	Unit is not plugged in.	Plug into mains power supply.
	Switch is not activated.	Press the On/Off. The switch will illuminate.
Unit heats up but fails to steam	Water tank is empty.	Refill the water tank according.
	Mineral build-up in unit.	Follow the removing mineral build-up guide.
	Thermofuse breakdown.	Take to a qualified person for inspection and repair.
Steam output is intermittent	Mineral build-up in unit.	It is normal for the unit to stop steaming periodically for a few seconds, If the steam remains off for longer periods, follow the removing mineral buildup guide

PLUG:

1. This appliance has been fitted with a BS UK compliant plug which should not be replaced or removed.
2. The plug is fitted with UK compliant fuse link which is suitable for this type of appliance and should only be replaced by a fuse link of the same rating.
3. If access to the fuse link is only possible by removing the plug cover this must only be done by a suitably qualified person.
4. If the plug or the mains cable of this appliance is damaged do not use and dispose of the appliance responsibly.
5. This appliance is earthed.

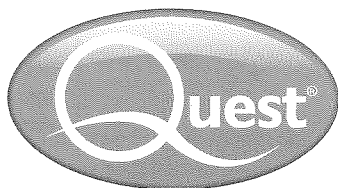

Information on Waste Disposal for Consumers of Electrical & Electronic Equipment



This symbol indicates that this product should not be treated as normal household waste and it should be recycled. Please take it to your nearest collection facility or for further details contact your local council or visit www.recycle-more.co.uk.



Imported by Benross®

MADE IN P.R.C